

## To the design engineer:

This catalog is designed to assist you in making the proper slide selection for your application. The information listed on this spread provides an overview of the slides available and pertinent information to consider when selecting a slide. The following pages provide a more detailed look at slides and mounting hardware. Additional information, technical sheets, and specific design criteria is available at [www.accuride.com](http://www.accuride.com).

### Factors to consider when selecting a slide

- Weight of chassis/drawer
- Side space available between chassis/drawer and rack/cabinet
- Height, width, and depth of chassis/drawer
- Depth of rack/cabinet
- Travel desired
- Application-specific requirements
- Disconnect of chassis/drawer needed
- Locks needed
- Mounting holes needed
- Optional mounting hardware for mounting in rack or enclosure

### Cross sections and load ratings

Load rating range is based on slide length. For more information, see the slide tables in this catalog or download the technical sheets from [www.accuride.com](http://www.accuride.com).

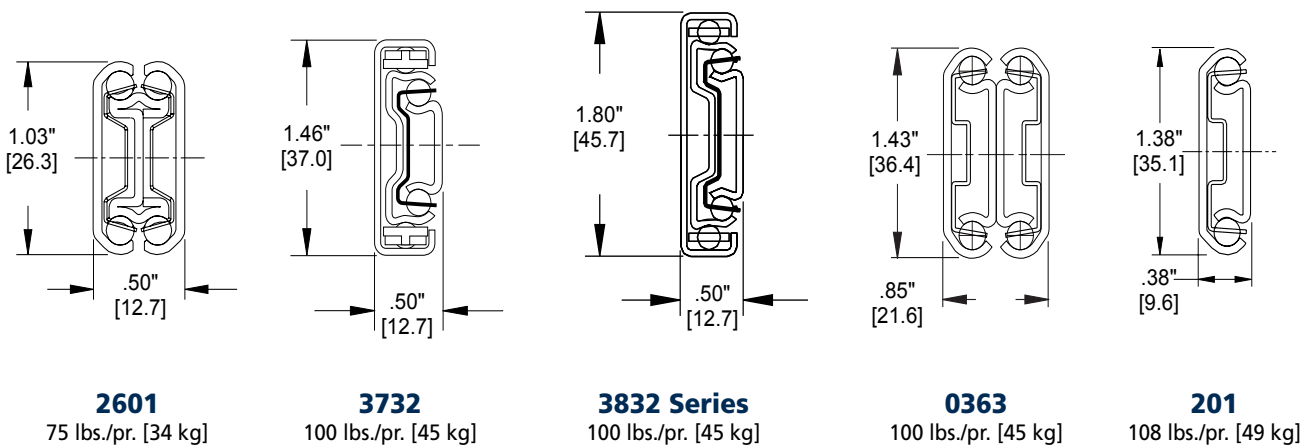
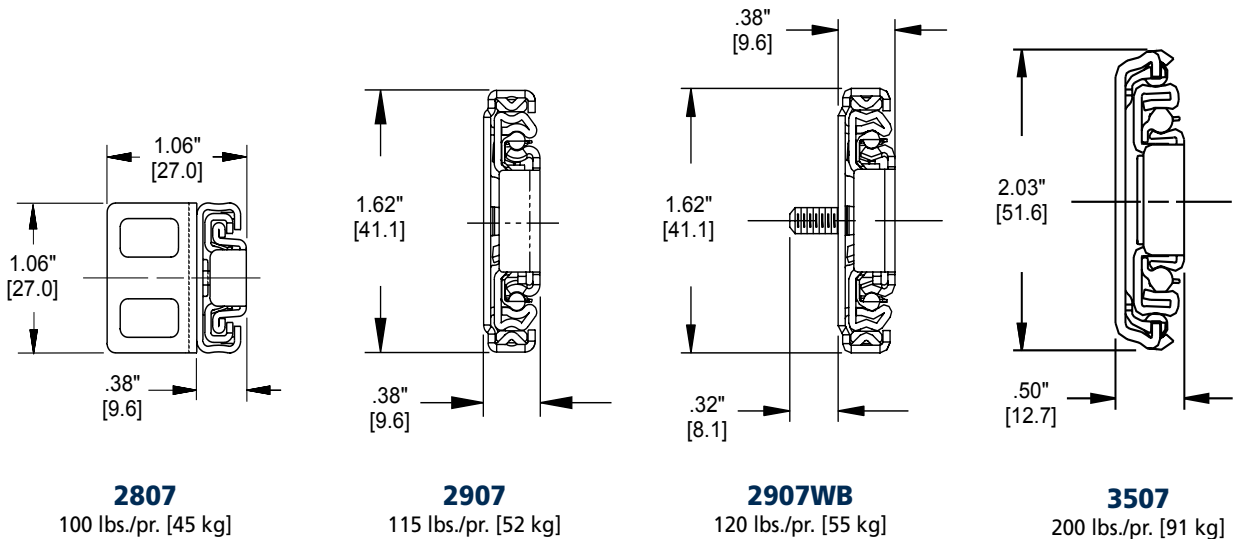

Get quote >>

Angic Global Solutions

1-888-872-0690

<https://www.AngicGlobal.com> Sales@AngicGlobal.com

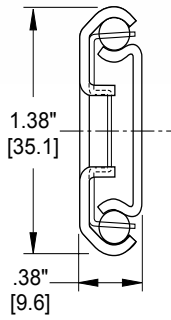

**204A-LR**  
140 lbs./pr. [64 kg]

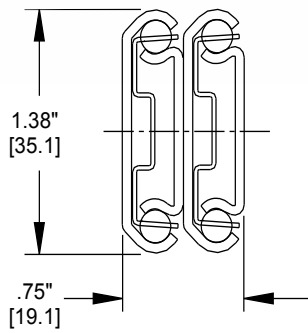

**305A-LR**  
140 lbs./pr. [64 kg]

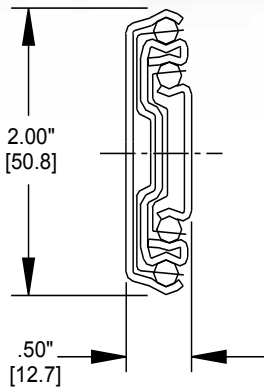

**3301/3307/3308/3357**  
150 lbs./pr. [68 kg]

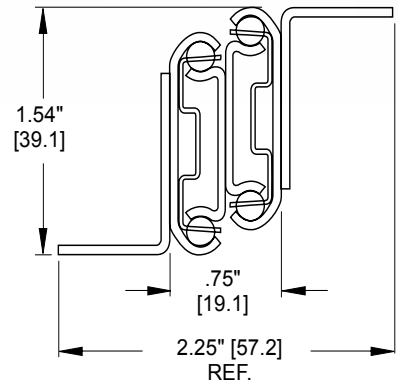

**301-2590**  
155 lbs./pr. [70 kg]

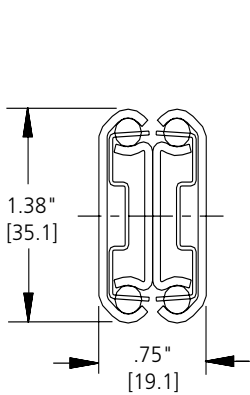

**301**  
175 lbs./pr. [80 kg]

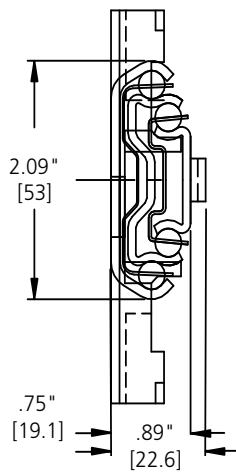

**3641**  
180 lbs./pr. [82 kg]

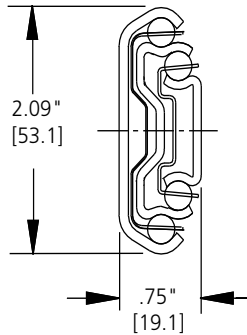

**3601**  
255 lbs./pr. [116 kg]  
**3600/3607/3657**  
273 lbs./pr. [124 kg]

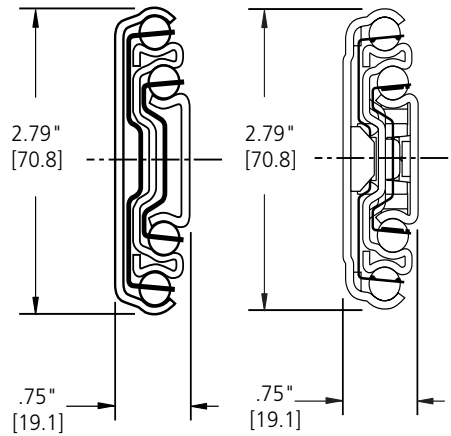

**7950/7957**  
350 lbs./pr. [159 kg]

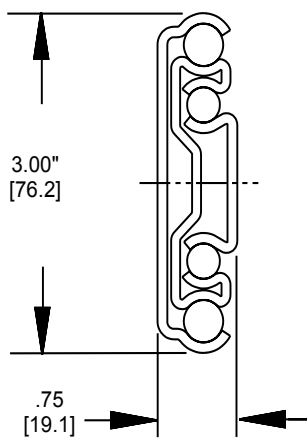

**9301/9307/9308**  
Up to 500 lbs./pr. [227 kg]\*

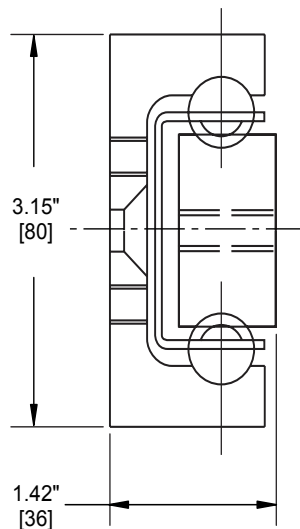

**AL4120**  
Up to 1,212 lbs./pr. [550 kg]

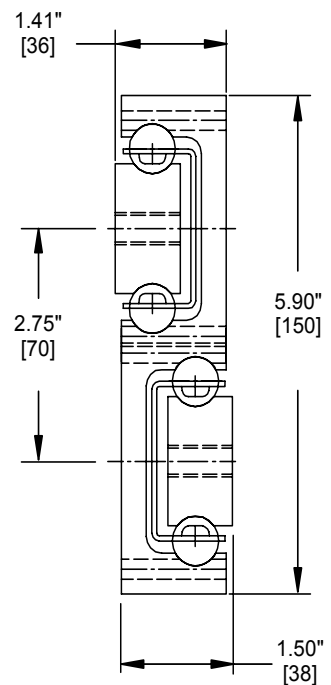

**AL4140**  
Up to 1,323 lbs./pr. [600 kg]



Get quote »

Angic Global Solutions

1-888-872-0690

<https://www.AngicGlobal.com> Sales@AngicGlobal.com

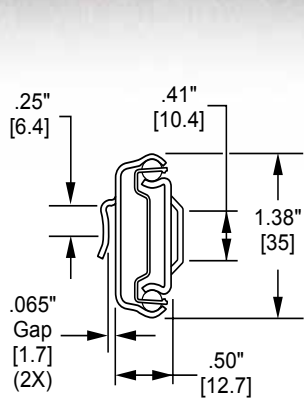

**2120**  
Up to 75 lbs./pr. [50 kg]

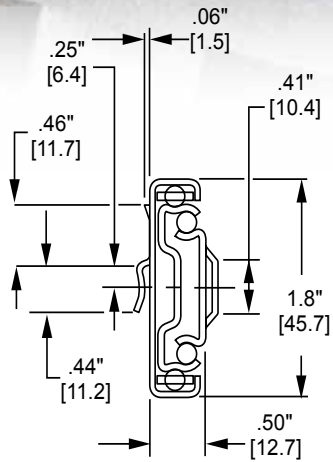

**3820**  
Up to 100 lbs./pr. [50 kg]

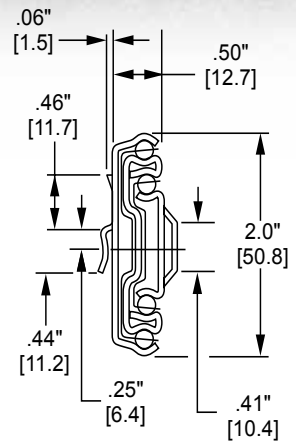

**3320**  
Up to 120 lbs./pr. [55 kg]

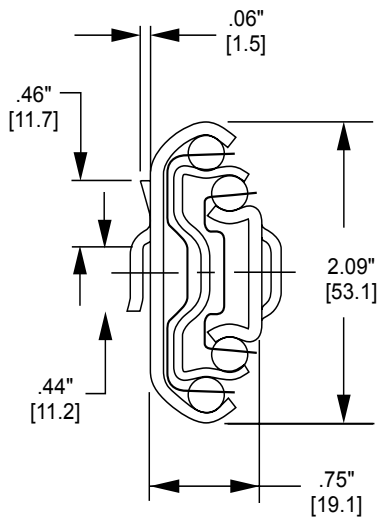

**3620**  
Up to 200 lbs./pr. [91 kg]

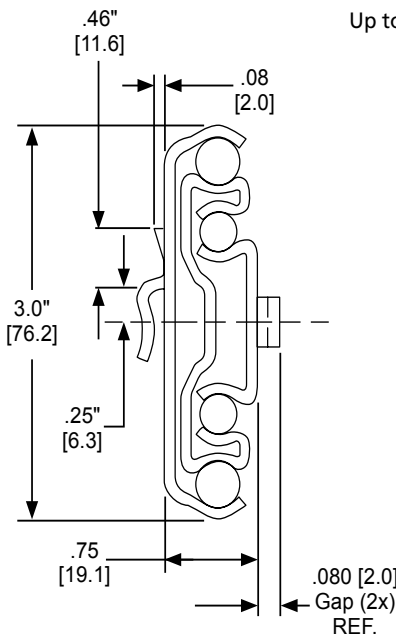

**9328/9322**  
Up to 300 lbs./pr. [136 kg]\*  
\* depending on usage

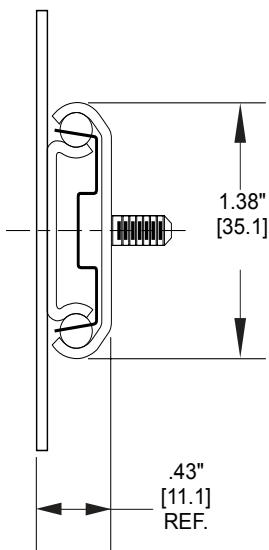

**115**  
Side Mount: 100 lbs./pr. [50 kg]  
Fl.

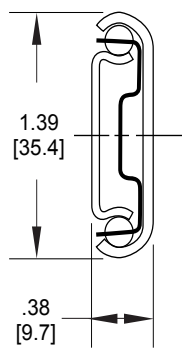

**SS2028**  
100 lbs./pr. [50 kg]

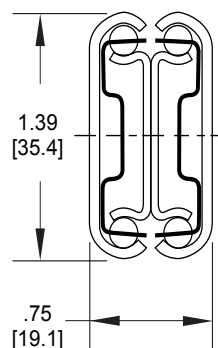

**SS0330**  
143 lbs./pr. [65 kg]

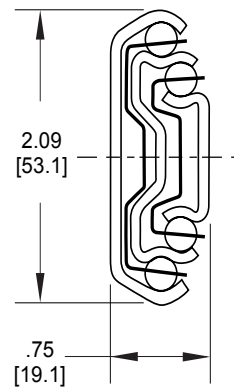

**SS5321**  
352 lbs./pr. [160 kg]



Get quote >>

Angic Global Solutions

1-888-872-0690

<https://www.AngicGlobal.com> Sales@AngicGlobal.com

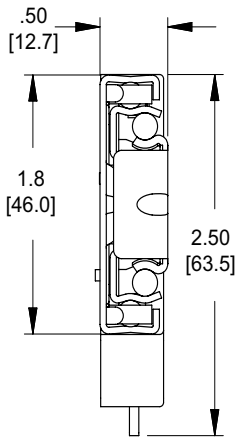

**38EL**  
Slide with Electronic Lock  
100 lbs./pr. [50 kg]

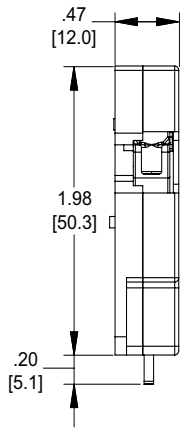

**10EL**  
Stand-Alone  
Electronic Lock

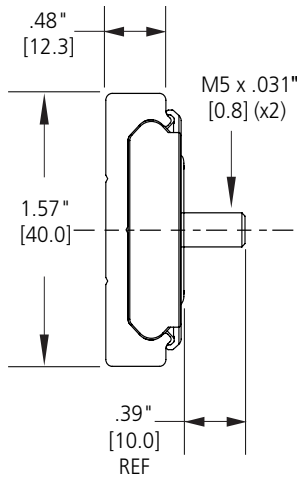

**115RC**  
Up to 265 lbs. [120 kg]

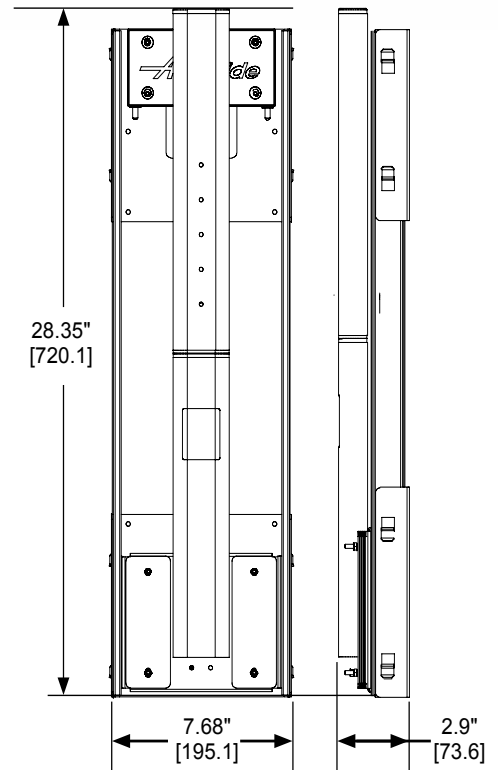

**Ascent CBLift-0019**  
Up to 14.5 lbs. [6.6 kg]

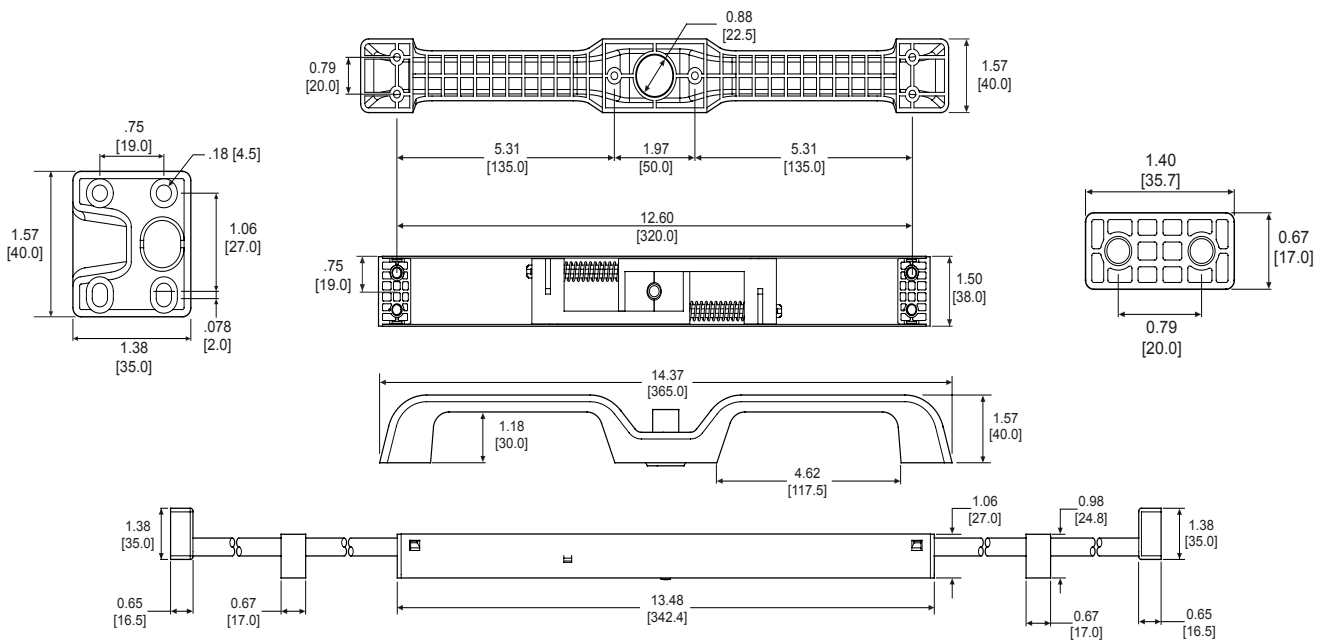

**CB-Hand**  
**Locking Handle Kits**  
Drawers up to 60" wide [1524 mm]



Get quote >>

Angic Global Solutions

1-888-872-0690

<https://www.AngicGlobal.com> Sales@AngicGlobal.com